



Wipers/Washers

Windshield Wiper Motor Replacement

NOTE:

- Take care not to damage the hood.
- Open the hood.

1. Remove the windshield wiper arms, then remove the hood seal and air scoop.

▷: Clip locations, 7

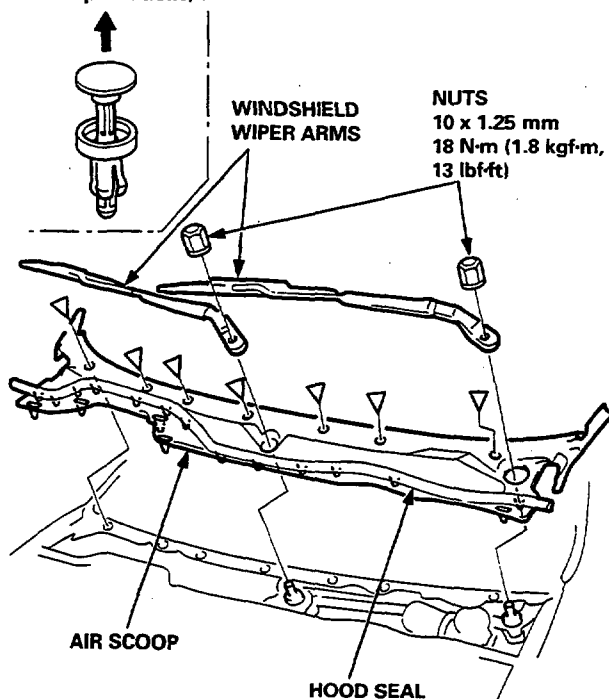

2. Disconnect the connector, then remove the windshield wiper linkage assembly.

▷: Bolt locations, 4

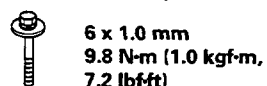

WINDSHIELD WIPER LINKAGE ASSEMBLY

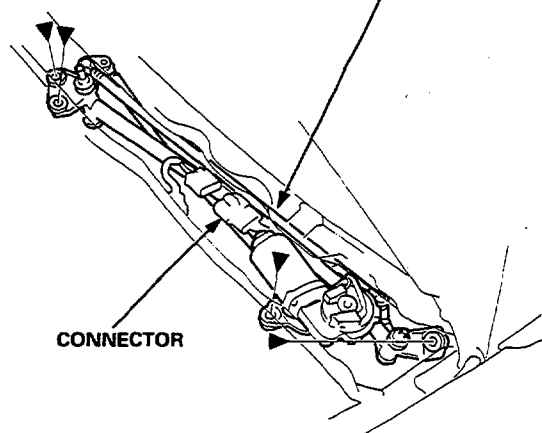

3. Separate the windshield wiper linkage and windshield wiper motor.

▷: Bolt locations, 3

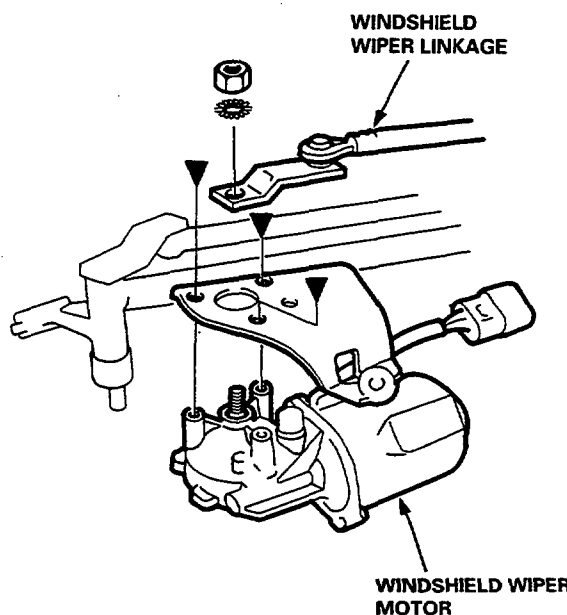
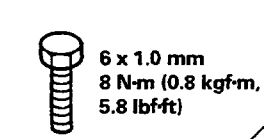

4. Installation is the reverse of the removal procedure.

NOTE:

- Make sure the connector is connected properly.
- If necessary, replace any damaged clips.
- Install the windshield wiper arms as shown below.
- Check the windshield wiper motor operation.

